

**NOTICE INVITING TENDER**  
**NO.: CUJ/OSD(PROJECT)/ 2012-13/MAY-01**

Date: 11/05/2012

O/o OSD (Project) on behalf of Central University of Jharkhand, Ranchi, invites sealed tenders from approved and eligible contractors of CPWD/PWD, and those of approved list of Central University of Jharkhand who are conversant to execute the works as under:

<b>Name of Work</b>	<b>CONSTRUCTION OF PARTITION WALL IN FLOOR NO.3 FOR OSD (PLANNING) &amp; ARCHITECTS AT CITY CENTRE, CENTRAL UNIVERSITY OF JHARKHAND, KANKE ROAD, RANCHI.</b>
<b>Date of issue of Tender Document</b>	14/05/2012 to 02/06/2012 (9:30am to 4:30pm)
<b>Date of Submission Tender Document</b>	On 04/06/2012 upto 1:00pm at Central University of Jharkhand, City Centre, Kanke Road, Ranchi- 834008
<b>Date/Time of opening of tender</b>	On 04/06/2012 at 3:00pm
<b>Time Allowed for Completion of Project</b>	30 days
<b>Cost of Tender Document</b>	A Bank Draft for Rs. 5000.00 (Rupees Five Thousands Only) "for each group" in favor of "Central University of Jharkhand" payable at S.B.I., Upper Bazaar Branch, Ranchi be attached with the bid (non-refundable).
<b>Earnest Money</b>	Rs. 20,000.00 (Rupees Twenty Thousands only) must be annexed with the Financial bid. vide Bank Draft in favour of "Central University of Jharkhand" payable at S.B.I., Upper Bazaar Branch, Ranchi

Tender document can be had from the Office of the O.S.D. (Project), Central University of Jharkhand, Kanke Road, Ranchi-834008, with written request for issuing of tender document, on all working days from the Project Office on payment of requisite cost of tender in form of Bank Draft in favor of "Central University of Jharkhand" payable at State Bank of India, Ranchi; or can be downloaded from university website <http://www.cuj.ac.in>.

1.
  - (a) **First Envelop** should be super scribed as "**TECHNICAL BID**" containing the **TECHNICAL SPECS** and firms credential; **TENDER COST**, in case the Tender Document is downloaded from the web site then the cost of the same must be enclosed; and **EMD**. The **TENDER COST & EMD** should be submitted vide Bank Draft only in favor of "Central University of Jharkhand" payable at S.B.I., Upper Bazaar Branch, Ranchi
  - (b) **Second Envelop** should be scribed as "**PRICE BID**" containing the quoted rate.

Both the above envelops (a) & (b) should be enclosed in one big envelop super-scribing as

**"TENDER DOCUMENT FOR CONSTRUCTION OF PARTITION WALL IN FLOOR NO.3 FOR OSD (PLANNING) & ARCHITECTS AT CITY CENTRE, CENTRAL UNIVERSITY OF JHARKHAND, KANKE ROAD, RANCHI."**

2. The Tender received without EMD and Tender Cost (in case the Tender downloaded from website) shall be summarily rejected.
3. If desired the tenderers or their authorized representatives only may be present on the day of opening of tender.
4. For clarification, if any, the same may be sought from the office of the undersigned at the above address.

5. The complete tender document is to be signed with seal & is to be placed in the technical bid envelope along with the necessary required catalogues/documents. The bidder shall submit satisfactory documentary proof. Authorized distributor/Principal certificate to be enclosed.
6. The tenderer should have supplied similar goods to other government organization and should produce documental evidence.
7. Central University of Jharkhand reserves the right to reject any or all prospective applicants without assigning any reason and to restrict the list of tendered contractors to any number deemed suitable by it, if too many applications are received satisfying the basic PQ criteria.
8. The decision of the Competent Authority of the University will be the final and binding to all. The Vice Chancellor, Central University of Jharkhand reserves the right to accept or reject any application and to annul the tender process and reject all applications at any time, without assigning any reason or incurring any liability to the applicants.
9. The University reserves the right to increase or decrease the scope of work or split the job. They are liable to change and must be considered only as advance information to assist the applicant.
10. If any information furnished by the applicant is found to be incorrect at a later stage, he shall be liable to be debarred from tendering/taking up of work in Central University of Jharkhand. The Central University of Jharkhand reserves the right to verify the particulars furnished by the applicant independently.
11. ***The rates must be quoted for service/materials, inclusive of all statutory taxes & levies; F.O.R City Centre, Central University of Jharkhand, situated at Kanke Road, Ranchi. No additional handling / liability charges will be entertained.***
12. Even though an applicant may satisfy the above requirements, University would be liable to disqualification if he has:
  - (a.) Made misleading or false representation or deliberately suppressed the information in the forms, statements and enclosures required in the pre-qualification document.
  - (b.) Record of poor performance such as abandoning work, not properly completing the contract, or financial failures/weakness etc.

-sd-

**Executive Engineer**

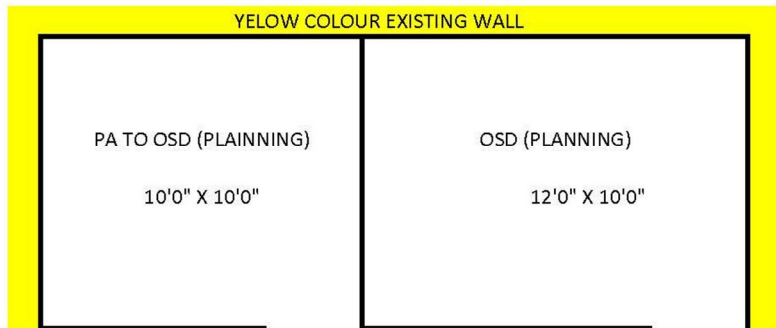
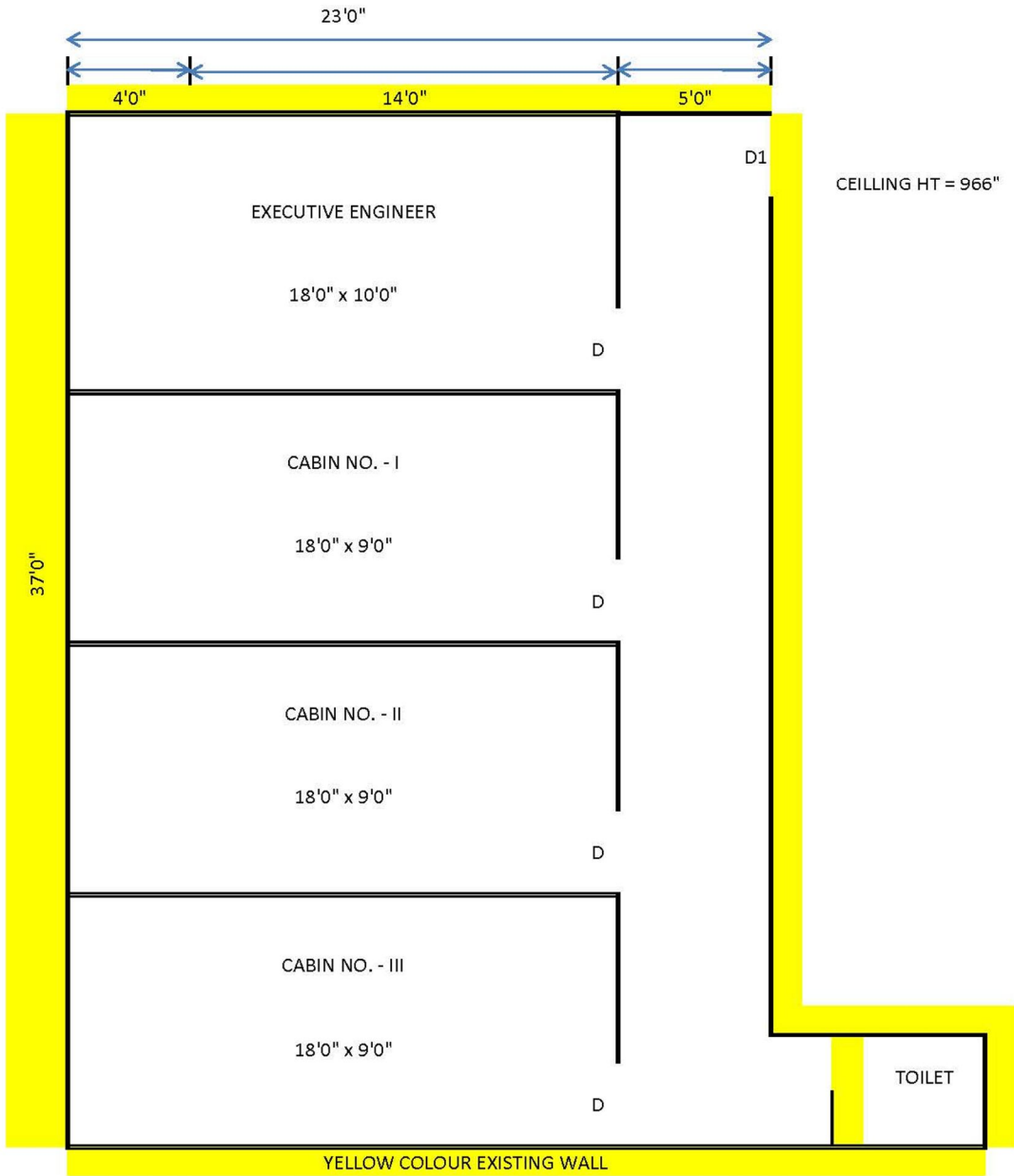

## BILL OF QUANTITY

SI.No.	DSR.NO.	ITEM DESCRIPTION	QTY.	UNIT	RATE/UNIT	AMOUNT
1.	21.1.2.3	Providing and fixing aluminium work for doors, windows, ventilators and partitions with extruded built up standard tubular sections/ appropriate Z sections and other sections of approved make conforming to IS: 733 and IS: 1285, fixing with dash fasteners of required dia and size, including necessary filling up the gaps at junctions, i.e. at top, bottom and sides with required EPDM rubber/ neoprene gasket etc. Aluminium sections shall be smooth, rust free, straight, mitred and jointed mechanically wherever required including cleat angle, Aluminium snap beading for glazing / paneling, C.P. brass / stainless steel screws, all complete as per architectural drawings and the directions of Engineer-in-charge. (Glazing, paneling and dash fasteners to be paid for separately) : Polyester powder coated aluminium (minimum thickness of polyester powder coating 50 micron)	1145.844	Kg.		
2.	21.3.2	Providing and fixing glazing in aluminium door, window, ventilator shutters and partitions etc. with EPDM rubber / neoprene gasket etc. complete as per the architectural drawings and the directions of engineer-in-charge . (Cost of aluminium snap beading shall be paid in basic item): With float glass panes of 5.50 mm thickness	48.792	M <sup>2</sup>		
3.	21.2.2	Providing and fixing 12mm thick pre-laminated particle board flat pressed three layer or graded wood particle board conforming to IS: 12823 Grade I Type II, in panelling fixed in aluminum doors, windows shutters and partition frames with C.P. brass / stainless steel screws etc. complete as per architectural drawings and directions of engineer-in-charge. Pre-laminated particle board with decorative lamination on both sides.	48.792	M <sup>2</sup>		
4.	N.S.	Providing & fixing of lock in door (Godrej) with all complete job.	6.000	each		

**TOTAL:** (in word) \_\_\_\_\_ (in figure) Rs. \_\_\_\_\_

**Signature of Contractor  
along with date & seal**